

Li-ion battery pack for charcoal smoker controller (AUB6800)

Version 1.2 (May 2016)

Warning: To reduce the risk of fire or burns, DO NOT attempt to open, disassemble, or service the battery pack. DO NOT crash, puncture, short external contacts, or dispose it in fire or water above 140°F. Please use supplied charger only.

Important: Must turn on the power switch to charge.

1. Specifications

AUB6800:

Operating/storage temperature: ≤ 140 °F

Capacity: 6800mAh/12V, 16000mAh/5V or 82WH

Voltage input: 12.6VDC

Voltage output: 12VDC (barrel connector), and 5VDC (USB)

Barrel connector: 5.5 mm O.D., 2.1 mm I.D.

Dimension: 124 x 73 x 29 mm (4.9 x 2.9 x 1.2")

Battery weight: 0.8 lb (12.9 oz)

AUB6800 charger:

Input voltage: 110-240VAC

Output voltage: 12.6VDC

Output maximum current: 1A

2. Names of parts

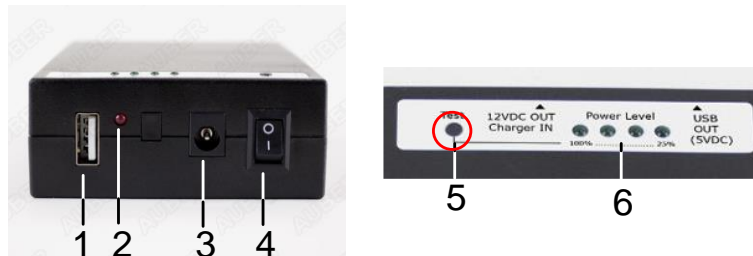

Figure 2. Names of parts on battery pack AUB6800.

1. USB (5V DC) power output
2. Power indicator
3. Power output / power input (12V DC)
4. Power switch
5. Testing button for remaining battery level
6. Battery level indicators (4 levels)

3. Package list:



Figure 1. Package list (from left to right):
Power adapter, Battery Pack, Output cable for SYL-1615

4. Testing the battery level

- 1) Flip the power switch on to turn on the battery pack. The red power indicator will lit.
- 2) Press the battery level testing button once. The battery level indicators will lit.
- 3) If all four green indicators are lit, estimated 100% power left in this battery. If three green indicators are lit, estimated 75% power left. If two green indicators are lit, estimated 50% power left. If one green indicator is lit, only 25% power left.

5. Charging the battery pack

- 1) Plug in the supplied charger to the wall outlet. A green LED indicator on the charger should lit.
- 2) Plug in the connector from the charger to the Power Input port on the battery pack.
- 3) Flip the power switch on to turn on the battery pack. The red power indicator on the battery pack will lit.
- 4) The indicator on the charger will turn red when the battery is charging. This indicator will turn green when the battery is fully charged or when the battery pack is turned off.

6. Using the battery pack with Auber's SYL-1615 charcoal smoker controller (or charging your mobile device):

- 1) Please follow instructions in section 4 to charge the battery before using it with SYL-1615.
- 2) Connect the power-out port of the battery pack and the power-in port of the SYL-1615 with the DC power cable (5.5 x 2.1 mm barrel connectors on both ends).
- 3) If you are charging a mobile device that needs 5VDC (such as a smart phone or a USB speaker), connect your device and the battery pack with a USB cable. using a USB cable, to either 5V DC power output socket or 12V DC power output socket on this battery pack.
- 4) Flip the power switch on to turn on the battery pack. The red power indicator on the battery pack will lit

Notes

- 1) With the smart Battery Managing System (BMS), the circuit will be automatically cut-off in case of any incorrect uses. To restart it, simply recharge it.
- 2) No USB cable is included.
- 3) One DC power cable with two 5.5 x 2.1 mm barrel connectors on both ends is included in the kit. Although one connector is yellow and one connector is black, they are the same. For SYL-1615 controller, there are two barrel connectors: one is 5.5 x 2.1 mm (for power input, on the bottom left), one is 5.5 x 2.5 mm (for supplying power to the blower). Please identify the correct connector for before connecting the battery pack to the SYL-1615 controller.